

ALCTC B5E-000-000

Install - Cover Page



Cover Page	I
Unpacking	I-0
Cabinet	I-1
Trim	I-2
Final Assembly	I-3

ALCTC B5E-000-000

Install - Unpacking

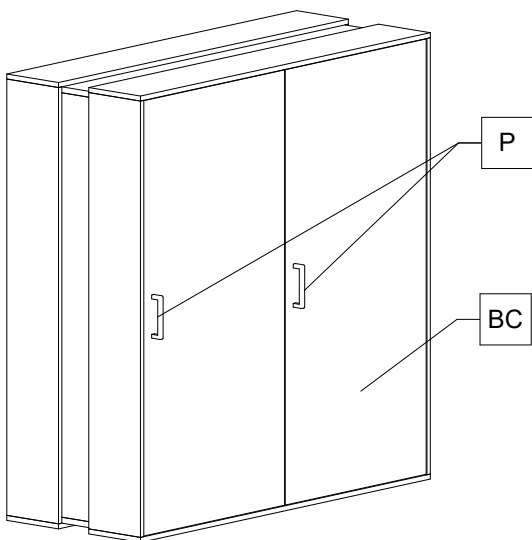

Packing List

Mark	Description	Qty
Cabinetry		
BC	Bi-Fold Cabinet	1
T	Accent Trim	8
Hardware		
	#12 3" Wood Screws	16
	#14 1-1/2" Cabinet Screws	32
P	Door/Drawer Pull	4

Skid A contains: Cabinets, Trim Package, Hardware

1. Remove all packing material.
2. REMOVE HARDWARE PACK.

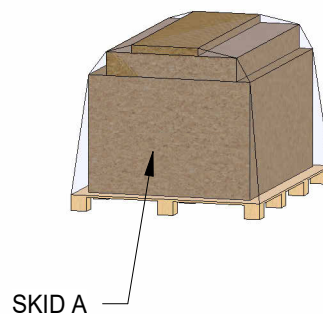

INSTALL CABINET

1. Place front cabinet in framed wall opening
2. Attach to wall with (16) wood screws. **[DETAIL CWS]**

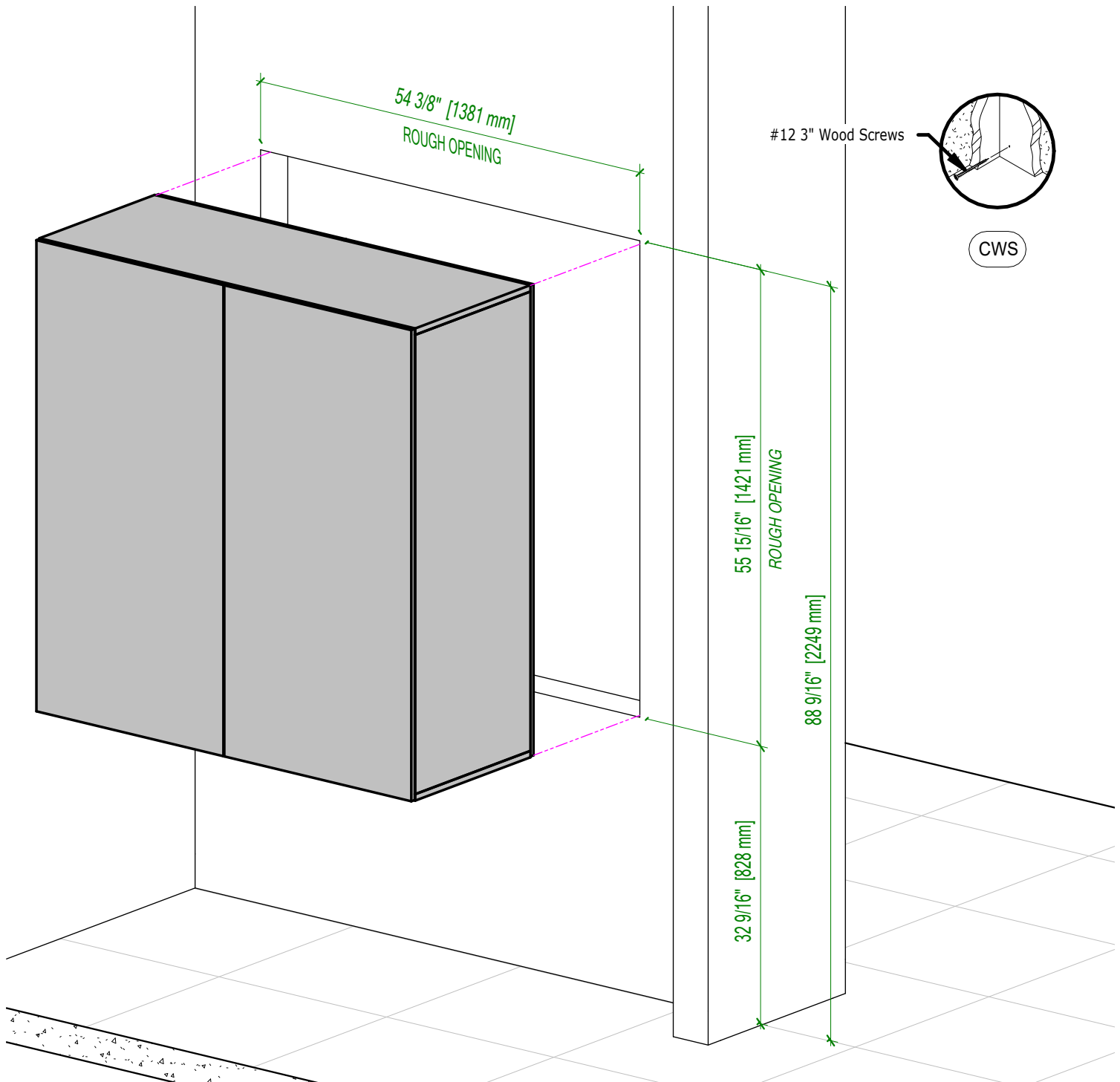

INSTALL TRIM

1. Place (8) Trim Boards as shown both sides of wall and attach to cabinet with with (32) wood screws each board. **[DETAIL CS]**

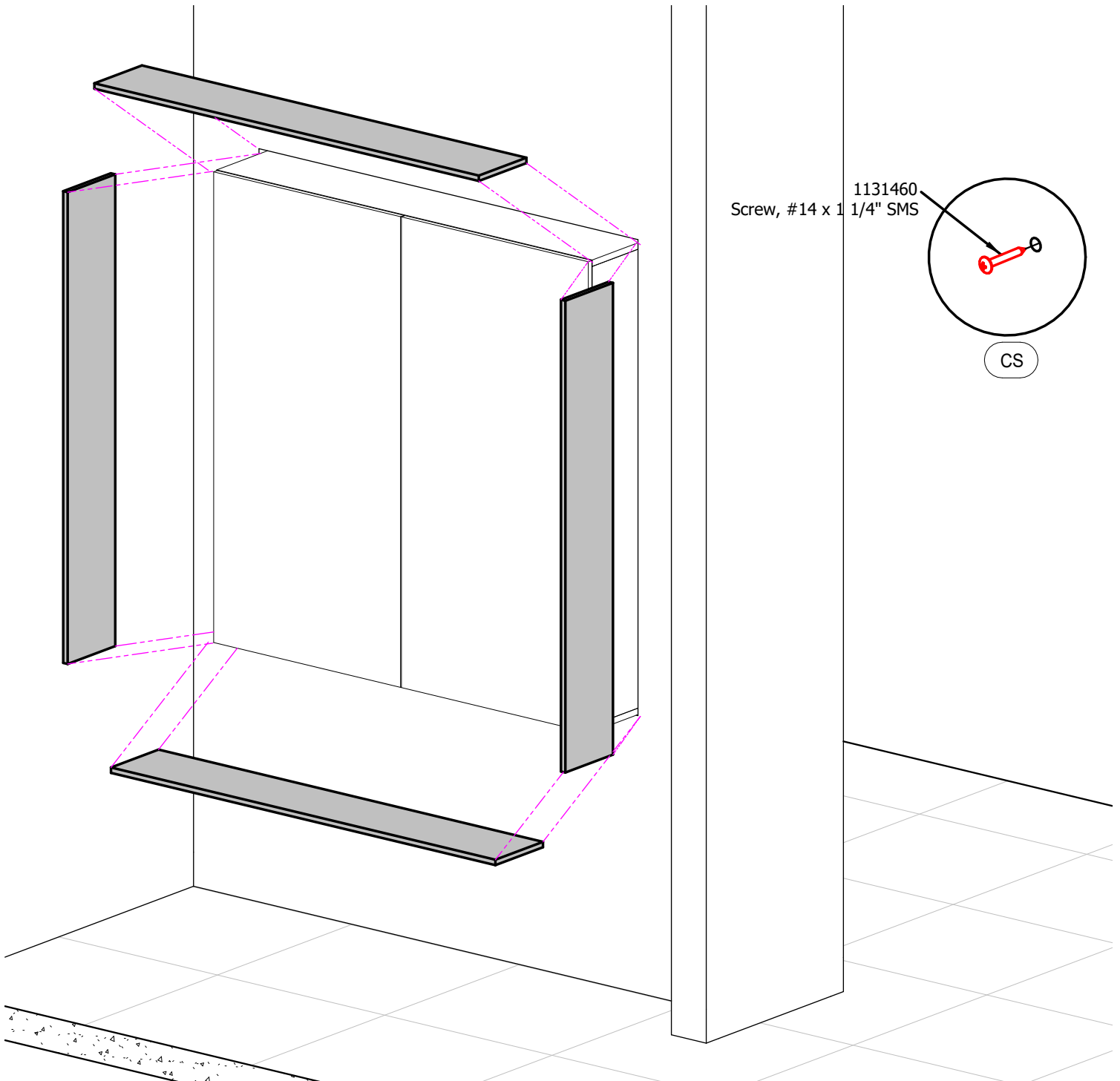

ALCTC B5E-000-000

Install - Final Assembly

****NOTE: FINAL ELECTRICAL & PLUMBING CONNECTIONS BY OTHERS****

1. REINSTALL DOORS/DRAWERS IN ORIGINAL POSITIONS FROM WHERE THEY WERE REMOVED.
2. Attach Door/Drawer Pulls and remaining components as needed.
3. CHECK FOR ALIGNMENT OF DOORS & DRAWERS, FINAL ADJUSTMENTS MAY BE NECESSARY.

